

# Banks Road, Eleuthera

Single Family Vacant

REF#51916

**COLDWELL  
BANKER** 

**LIGHTBOURN  
REALTY**

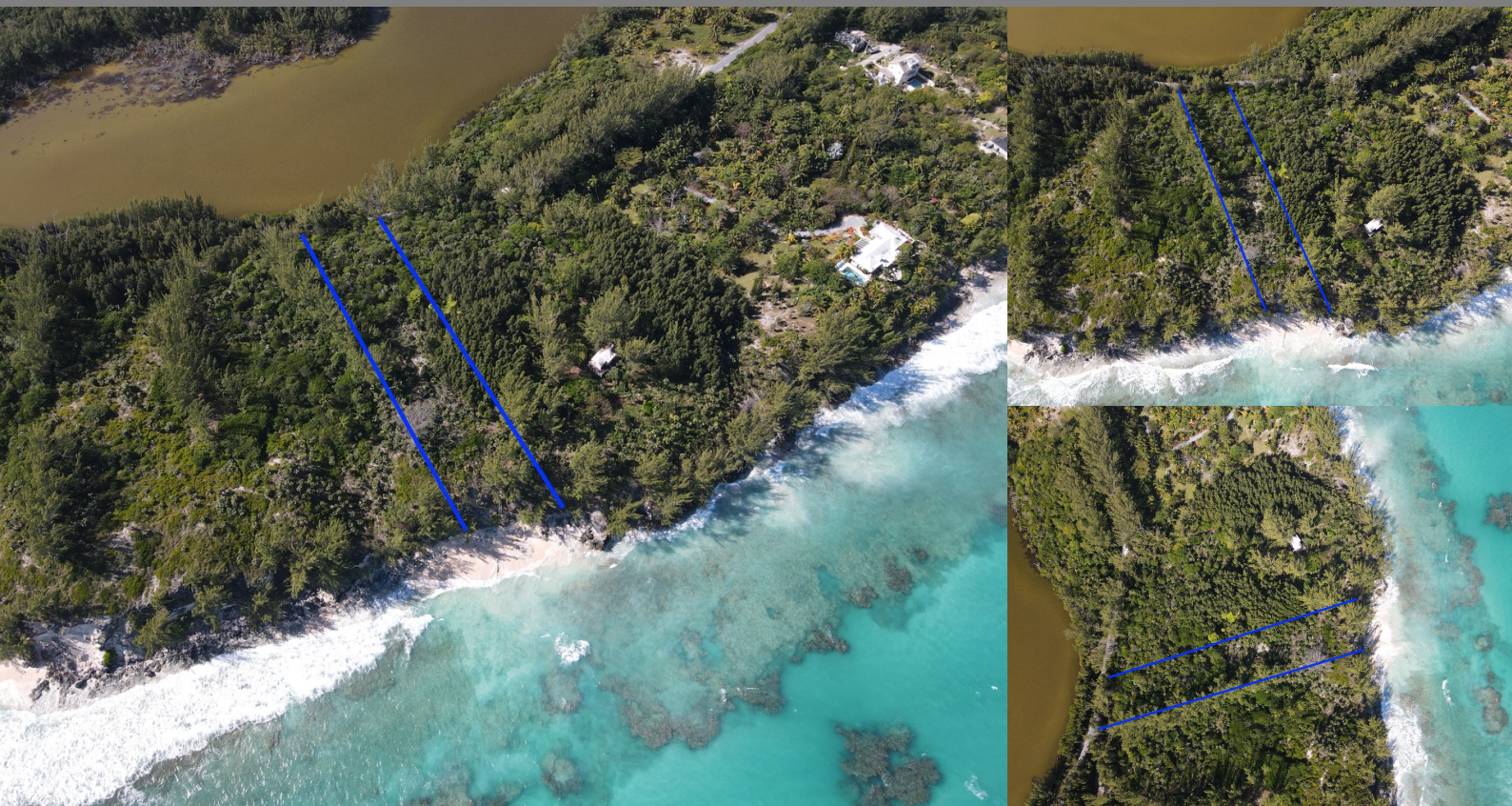

LOT SIZE

1.05 acres

**\$445,000**

Location: Banks Road, Eleuthera

Amenities: Beach Access,Ocean Front,Ocean View.

Summary: Peppercorn East Lot, North Palmetto Point is one of the last available lots in this prime residential beachfront area of Eleuthera, the jewel of The Bahamas. An incredible, beautifully elevated beachfront lot located on the Bank's Road with paved road access and all utilities available right to the lot: electricity, water, internet and phone.

This 1.05 acre parcel offers 90 feet on the Atlantic Ocean with elevations of over 40 feet. An excellent vantage point, affording commanding ocean views into the far horizon and gentle tropical breezes year round. The lot is wooded with beautiful mature trees that can be incorporated into the landscaping and will need little maintenance. Enjoy your morning coffee with the beautiful Bahamian sunrises greeting you each day and have your evenings full of soft sunset light, filtering in through your windows.

The ideal location to build your dream vacation home, directly on a powdery pink sand beach, with fantastic swimming, snorkeling and fishing right in front of your property. Well above the high water line, offering safety under almost all conditions.

Shannon Knowles

Eleuthera, Bahamas

Cell: 242 427.0977

Email: shannon@cbbahamas.com

cbbahamas.com

