

Whale Point Estates, Eleuthera

Single Family Vacant

REF#54219

**COLDWELL
BANKER**

**LIGHTBOURN
REALTY**

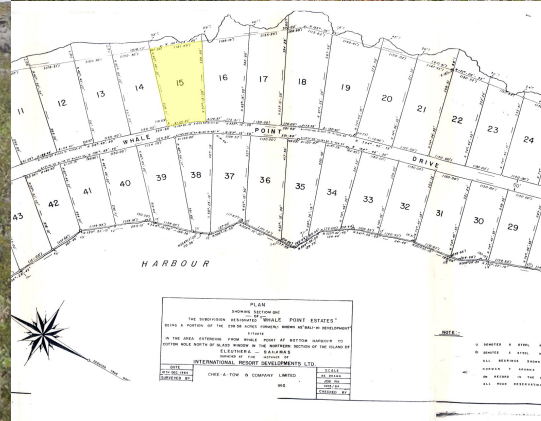

LOT SIZE

1.325
acres

\$275,000

Location: Whale Point Estates, Eleuthera

Amenities: Ocean Front,Ocean View,Pet Friendly.

Summary: This large elevated property is located in the quiet Whale Point Estates Subdivision, North Eleuthera, Bahamas. At ground level there are spectacular views of the Atlantic Ocean and Bottom Harbour. It is less than 10 minutes from World Famous Harbour Island by boat. Located just 25 minutes from the North Eleuthera International Airport with daily flights to and from Nassau and the United States. About 2 miles north of Gregory Town and near to the Glass Window Bridge. This subdivision has a number of private beaches and is ideal for a vacation or retirement home. Electricity available.

Eddie Minnis

Eleuthera, Bahamas
Cell: (242) 359.7328
Email: eddie@cbbahamas.com
cbbahamas.com

